



Fasteners And Products Catalogue

Striving To make your day easier
Our quality and customer service is paramount



About Us

- **Mission Statement**

“Fastener Center a Division Production Components Inc “is dedicated to maintaining a high level of quality and reliability in serving our customers. Our company is committed to continuous improvements in quality and timely delivery in order that you our valued customers may meet their contractual and operational requirements. Management's prime objective to lead though the implementation of strict quality programs. The Employees, who are encouraged to continually grow through training, recognize the importance of quality in industry and are involved in the improvements of the company's quality program

- **Fastener Center is a Fastener Distributor located in Woodstock Ontario for 10 years now . We carry a large range of industrial hardware in a variety of grades and plating choices. Whether your requirements are for metric or imperial measures we can supply your needs.**

- **We are a distributor of imperial as well as metric , in various finishes and materials , zinc, zinc yellow , cad & wax , stainless, brass**
- **We are known for our ability to find those hard to find items**



SCREWS

**Fastener
Center**
A DIVISION OF PRODUCTION COMPONENTS INC.



Bolts

***Fastener
Center***
A DIVISION OF PRODUCTION COMPONENTS INC.



Square Head
Plow Bolt



Hex Head
Cap Screw (Bolt)

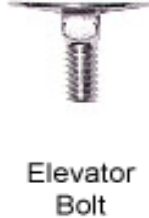

Elevator
Bolt



Carriage
Bolt



Hex Head
Lag Screw (Bolt)



T-Head
Bolt

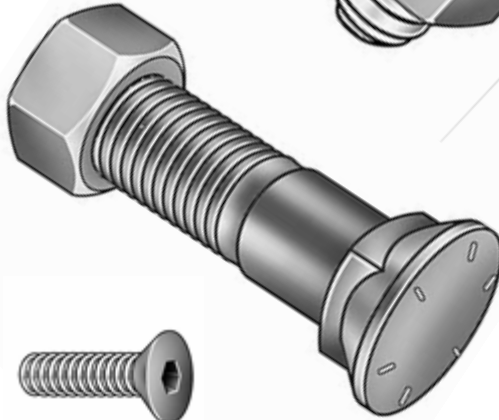
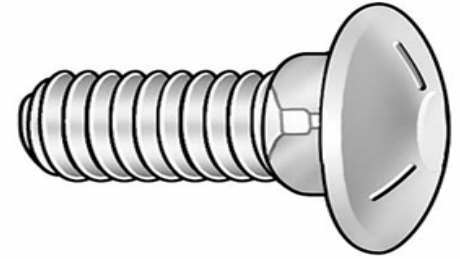

Bolts

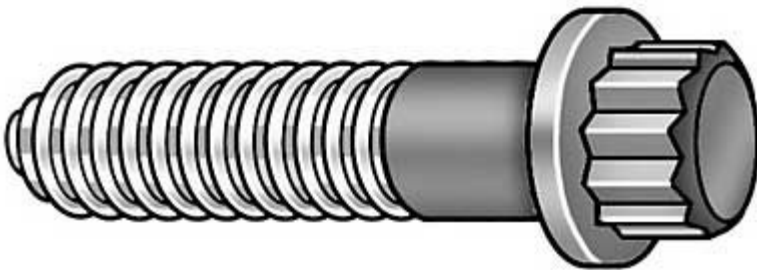
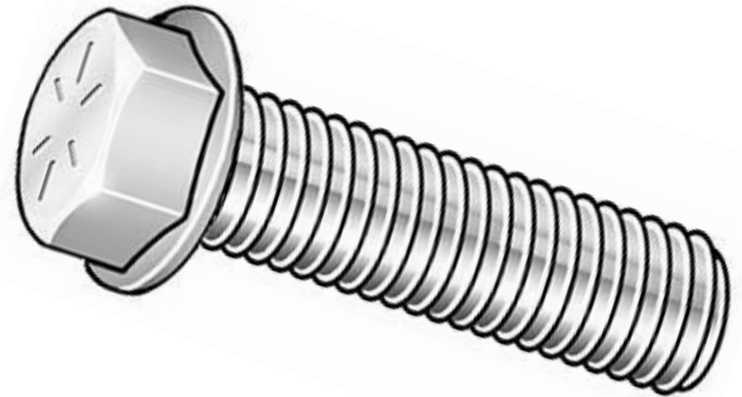

Imperial Bolts Sizes

Sizes Usually Available

1/4 -20
1/4 -28
5/16-18
5/16-24
3/8 -16
3/8 -24
7/16-14
7/16-20
1/2 -13
1/2 -20
9/16-12
9/16-18
5/8 -11
5/8 -18
3/4 -10
3/4 -16
7/8 - 9
7/8 -14
1 - 8
1 -14
1- 1/8 - 7
1- 1/4 - 7
1- 3/8 - 6
1- 1/2 - 6
1- 3/4 - 5
2-4.5

Lengths Usually Available

1/4 in. 3/8 in. 1/2 in. 5/8 in. 3/4 in. 7/8 in. 15/16 in. 1 in. 1- 1/16 in. 1- 1/8 in. 1- 3/16 in. 1- 1/4 in.

1- 5/16 in. 1- 3/8 in. 1- 1/2 in. 1- 5/8 in. 1- 3/4 in. 1- 7/8 in. 2 in. 2 1/8 in. 2- 1/4 in. 2- 1/2 in.

2- 5/8 in. 2- 3/4 in. 3 in. 3- 1/4 in. 3-1/2 in. 3- 5/8 in. 3- 3/4 in. 4 in. 4- 1/4 in. 4- 1/2 in.

4- 3/4 in. 5 in. 5 1/2 in. 6 in. 6- 1/4 in. 6- 1/2 in. 6- 3/4 in. 7 in. 7- 1/2 in. 8 in. 8- 1/4 in.

8- 1/2 in. 9 in. 9- 1/2 in. 10 in. 11 in. 12 in. 13 in. 14 in. 16 in. 18 in.

**Fastener
Center**
A DIVISION OF PRODUCTION COMPONENTS INC.

Metric Bolts Sizes

Metric Sizes *Usually Available*

M3 M4 M5 M6 M7 M8 M10 M12 M14 M16 M18

M20 M22 M24 M27 M30 M33 M36 M42 M48

Metric Lengths *Usually Available*

6MM 8MM 10MM 12MM 14MM 20MM 22MM 25MM 28MM 30MM

35MM 40MM 45MM 50MM 55MM 60MM 65MM 70MM 75MM 80MM

85MM 90MM 100MM 110MM 120MM 130MM 140MM 150MM 160MM 170MM

180MM 200MM 220MM 240MM 260MM 280MM 300MM 320MM 340MM 360MM

400MM 460MM



Socket Product



Rod End



Socket Set Screw



Elevator Bolt



Button Socket Cap Screw



Flat Head Socket Cap Screw

Sizes Usually Available

- 2-56
- 4-40
- 5-40
- 6-32
- 8-32
- 10-32
- 10-24
- 1/4 -20
- 1/4 -28
- 5/16-18
- 5/16-24
- 3/8 -16
- 3/8 -24
- 7/16-14
- 7/16-20
- 1/2 -13
- 1/2 -20
- 5/8 -11
- 5/8 -18
- 3/4 -10
- 3/4 -16
- 7/8 - 9
- 7/8 -14
- 1 - 8
- 1 -14
- 1 1/4 - 7
- 1 1/2 - 6

Lengths Usually Available

- 3/16 in.
- 1/4 in.
- 5/16 in.
- 3/8 in.
- 1/2 in.
- 5/8 in.
- 3/4 in.
- 7/8 in.
- 1 in.
- 1 1/8 in.
- 1 1/4 in.
- 1 1/2 in.
- 1 3/4 in.
- 2 in.
- 2 1/4 in.
- 2 1/2 in.
- 2 3/4 in.
- 3 in.
- 3 1/4 in.
- 3 1/2 in.
- 3 3/4 in.
- 4 in.

Lengths Usually Available

- 4 1/4 in.
- 4 1/2 in.
- 4 3/4 in.
- 5 in.
- 5 1/2 in.
- 6 in.
- 6 1/4 in.
- 6 1/2 in.
- 7 in.
- 7 1/2 in.
- 8 in.
- 8 1/2 in.
- 9 in.
- 9 1/2 in.
- 10 in.
- 11 in.
- 12 in.



Socket Product Imperial

Metric Sizes Usually Available											
M2	M3	M4	M5	M6	M7	M8	M10	M12	M14	M16	M18
M20	M22	M24	M27	M30	M33	M36	M42	M48			
Metric Lengths Usually Available											
3MM	4MM	6MM	8MM	10MM	12MM	14MM	20MM	22MM			
25MM	28MM	30MM	35MM	40MM	45MM	50MM	55MM	60MM			
65MM	70MM	75MM	80MM	85MM	90MM	100MM	110MM	120MM			
130MM	140MM	150MM	160MM	170MM	180MM	200MM	220MM	240MM			
260MM	280MM	300MM	320MM	340MM	360MM	400MM	460MM				



Socket Product Metric

Nuts

**Fastener
Center**
A DIVISION OF PRODUCTION COMPONENTS INC.



Square



Wing



Jam



Heavy Hex



Keps



Finished Hex



Nylon Insert



Machine Screw



Spacer



Weld



Cap (Acorn)



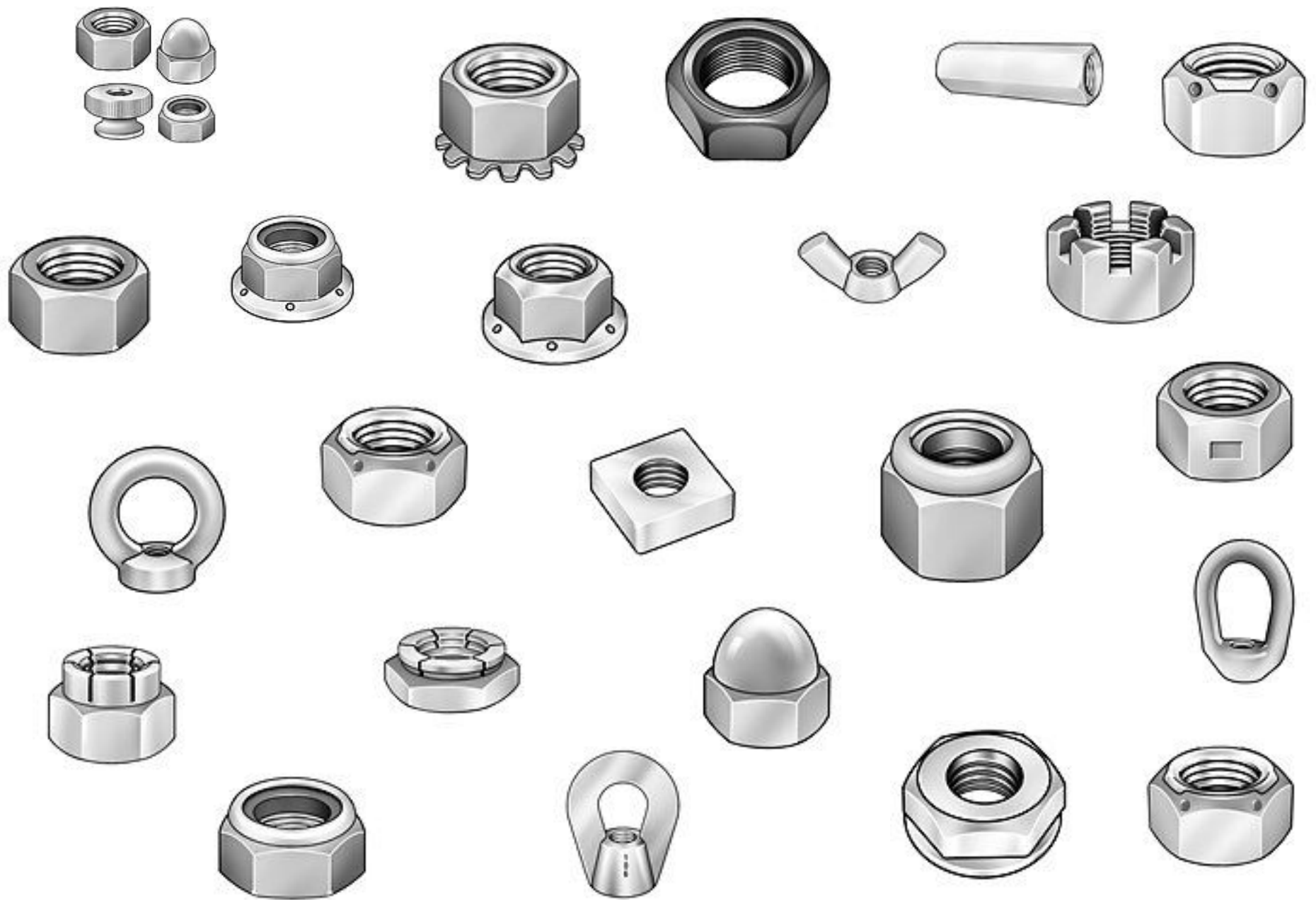

***IN ADDITION TO THE WIDE VARIETY OF FASTENERS,
WE ALSO STOCK AND SUPPLY THE FOLLOWING:***

**Carriage Bolts
Eye Bolts
Lifting Eye Bolts
Cotter Pins
Roll Pins
Threaded Rod
Hex Bar
Key Stock
Parallel Keys
Threaded Inserts
Belts
Gears
Chain
Tamper Proof Screws
Thumb Screws
Thumb Screw Knobs
Pipe Plugs
Grease Fittings
O-Rings
O-Ring Assortments
Rivets
Sealing Rings
Spiral Pins
Stand-Offs**



***Fastener
Center***
A DIVISION OF PRODUCTION COMPONENTS INC.

Bins And Cabinets

***Fastener
Center***
A DIVISION OF PRODUCTION COMPONENTS INC.



Drives And Threads

**Fastener
Center**
A DIVISION OF PRODUCTION COMPONENTS INC.



1



A



23



AB



25



B



C



F



Hi-Lo



Wood Screw



Binding



Fillister



Socket
Pin-Head



Phillips
Pin-Head



Slot



Hex Socket



Round



Hex Washer
Head



Fillister



Truss



Oval



Flat

Washers, Roll, Dowel, Cotter Pins



Flat



Spring Roll Pin



External Tooth



Finishing



Beveled



Cotter Pins



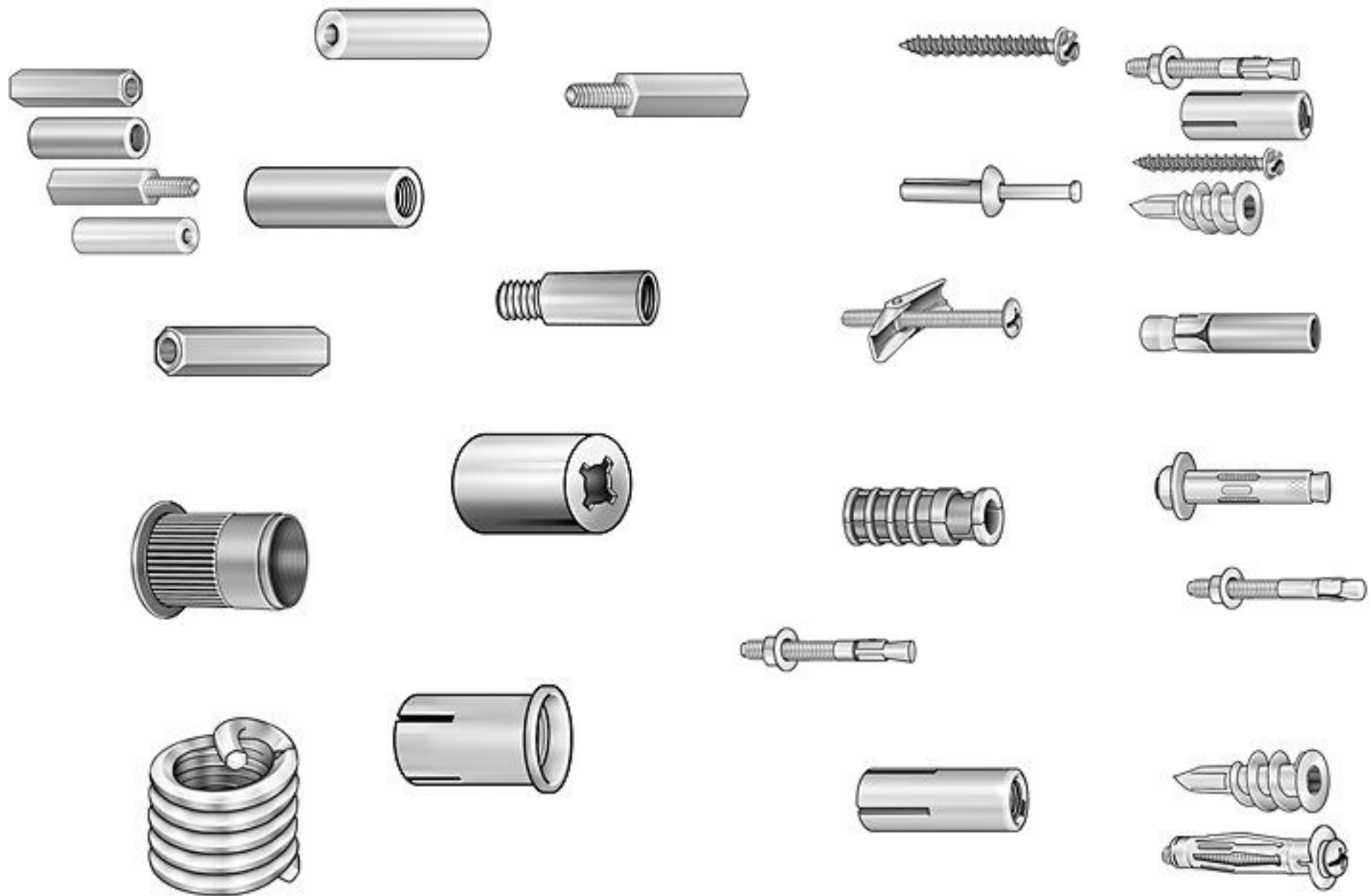

Accessories

**Fastener
Center**
A DIVISION OF PRODUCTION COMPONENTS INC.



Bent
Eye Bolt



Full Thread
Rod



Double Ended
Stud



Single Ended
Stud



Chain



Blind Rivet



Forged
Eye Bolt



Square Head
Plow Bolt



Wedge
Anchor Bolt



Fittings

**Fastener
Center**
A DIVISION OF PRODUCTION COMPONENTS INC.



Wire Rope & Clips

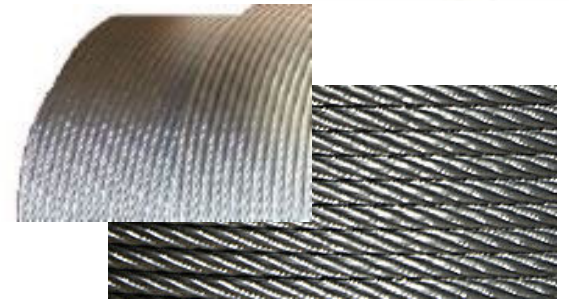

**Fastener
Center**
A DIVISION OF PRODUCTION COMPONENTS INC.

Hinges

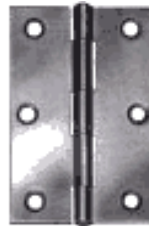

Terminals & Electrical Wire



NUTS	ABRASIVES	BOLTS
<ul style="list-style-type: none"> •Hex Grades 2, 5, 8 & 9 •Wing Nuts •Acorn Nuts •Slotted Nuts •Square Nuts •Nylon Insert Lock Nuts • Lock Nuts •Coupling Nuts •Jam Nuts •Tee Nuts •Push Nuts •Cage Nuts •Spring Type 	<ul style="list-style-type: none"> •Sanding Discs •Wire Wheels •Scratch Brushes •Grinding W eels •Cut Off Wheels •3M 	<ul style="list-style-type: none"> •T Slot Bolts •Elevator Bolts •Hanger Bolts •Carriage Bolts •Hook Bolts •Step Bolts •A325 •Eye Bolts •Plow Bolts •Lag Bolts •Hex Grades 2, 5, 8, L9 •Shaker Screen •Scraper Blade •Full Thread (Tap Bolts) •Socket Set Screws •Socket Cap Screws •Square Head •Anchor •U Bolts

WASHERS	SCREWS	SPECIALS
<ul style="list-style-type: none"> •USS or SAE Flat •Fender Washers •Lock Washers •Finishing Washers •Bevel Washers •Sealing Washers •Disc Spring Washers •Hardened Washers •Fibre Washers •High Collar Washers 	<ul style="list-style-type: none"> •Machine •Tapping •Drywall •Slotted Set • Tapcon •Wood •Floor Board Thumb •Socket Set •Weld •Tamper Resistant •Thread Cutting 	<ul style="list-style-type: none"> •U Bolts •J Bolts •Hook Bolts •Anchor Bolts •Drilled Holes •Special Lengths •Special Threads •Exotic Materials

CONCRETE ANCHORS	LUBRICANTS & ADHESIVES	PINS & RIVETS
<ul style="list-style-type: none"> •Red Head Sleeve •Red Head Wedge •Single & Double •Expansion Shields •Ramset Pins & Loads •Hollow Wall Anchors •Plastic & Lead Screw •Anchors •Stud Bolt Anchors •Drop Ins •Lag Shields •Hammer Drill Bits •TAPCON® 	<ul style="list-style-type: none"> •Thread Lockers •Sealants •Cleaners & Degreasers •Epoxies •Silicones •Instant Adhesives •Anti Seize •Penetrating Fluids •Industrial Lubricants 	<ul style="list-style-type: none"> • Rivets •Solid Steel Rivets •Pin Grip Rivets •Semi-Tubular Rivets •Rivet Tools •Hammerlock Cotter •Clevis Pins •Cotter Pins •Taper Pins •Dowel Pins •Slotted Spring Pins •Spirally Coiled Pins •Groove Pins

CHAIN, WIRE ROPE & FITTINGS	BINS & TRAYS	CUTTING TOOLS
<ul style="list-style-type: none"> •Eye Bolts •Shackles •Hooks •Clevis Yokes •Turnbuckles •Clevis & Slip Hooks •Chain - Grades 30, 40, •Wire Rope •Slings - Chain, Nylon & •Wire Rope •Swivels •Aircraft Cable •Electric & Chain Hoists 	<ul style="list-style-type: none"> •Bolt Bins •Service Trays •Slide Racks •Pull-Out Compartments •Literature Racks •Trays 	<ul style="list-style-type: none"> •Taps & Dies •High Speed Steel Drill Bits •Drill Bits •End Mills •Reamers •Countersinks

INDUSTRIAL SUPPLIES

- Measuring Tapes
- Key Stock - Drill Rod
- Rope
- Hose Clamps
- Brass Fittings
- Screwdriver Bits
- Nylon Cable Ties
- Hand Cleaners
- Helicoil Thread Repair Inserts
- Screw Eyes & Eye Bolts
- Cleaners & Degreasers
- Latex Gloves
- Continuous Hinge
- O-Rings, Retaining Rings
- Woodruff Keys
- Screwdrivers
- Beam Clamps
- Utility Knives
- Duct Tape
- Electrical Tape
- Shim Stock

Stainless Nuts

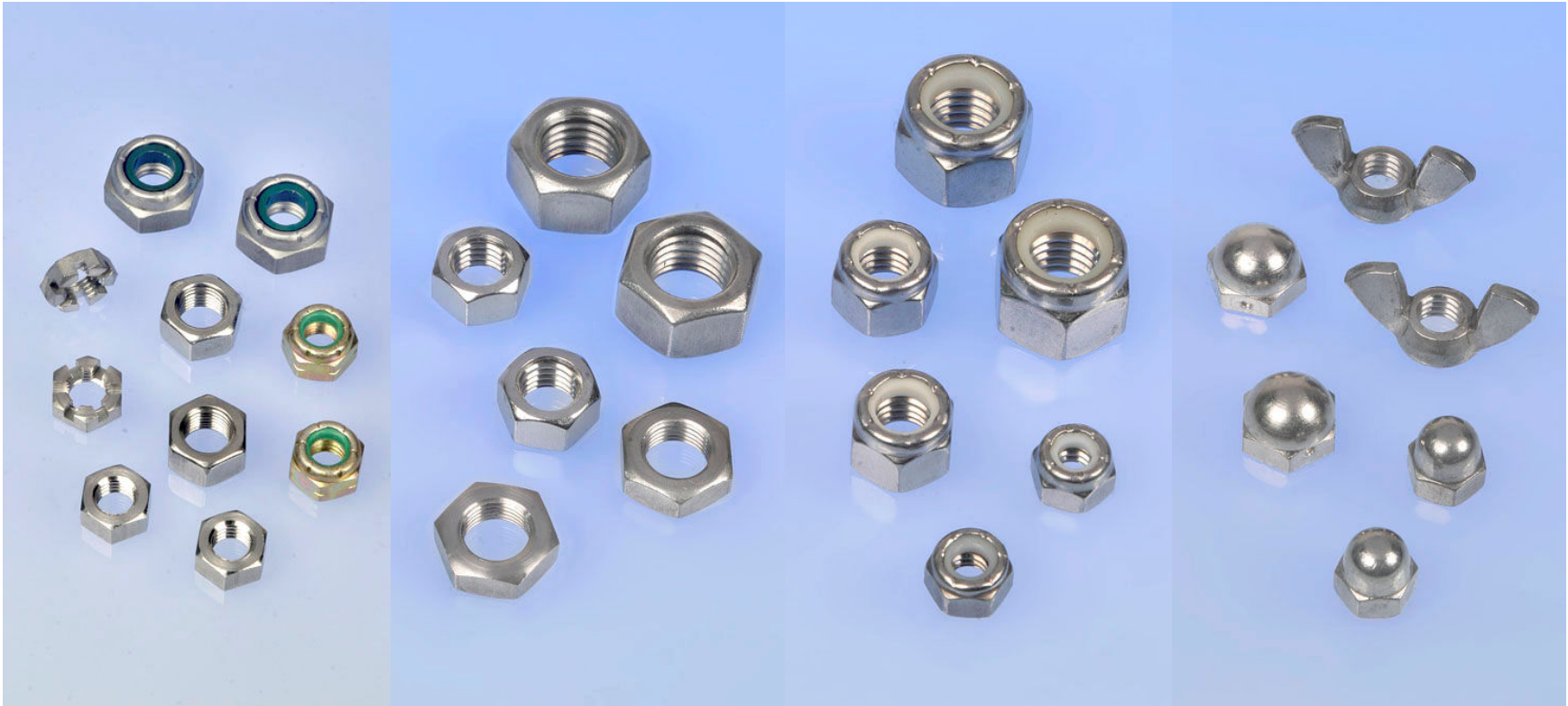

Stainless Metric Bolts



Stainless Pins and Dowels



Stainless Tamper Proof Screws



Stainless Spacer, Set & Socket Screws



Stainless



Stainless Washers



Tamper Proof & Hex Keys



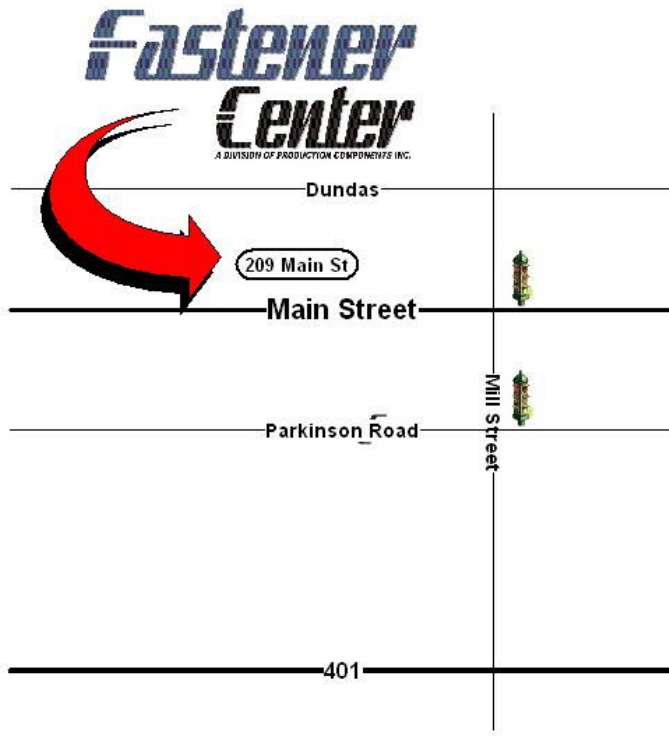

Fastener Center
A Division of Production Components Inc.
209 Main St.

Woodstock, Ont. N4S 1T1

Phone : 1-519-533-0909

Fax : 1-519-533-0909

Web Page : www.prodcompinc.com

E-Mail: prodcomp@execulink.com



Services Include:

- Unusual or Special-orders
- Hard-to-find Items
- Complex Variety of Sizes, Materials, Finishes
- Special Delivery Requirements or Rush Orders
- Free Delivery